



FR 372 VGC ST

Freezer verticale statico con agitatore
Static-fan assisted vertical freezer



FR 372 V ST BLACK/WHITE

Freezer verticale statico con agitatore
Static-fan assisted vertical freezer



Colori disponibili / Available colors

	Bianco / White
	Nero / Black

Cassonetto retroilluminato
Backlight canopy



Refrigerazione statica
Static refrigeration



Motoventola tangenziale
Tangential fan motor



Caratteristiche / Features

Modello / Model	FR 372 VGC ST	FR 372 V ST BLACK/WHITE
Temperatura / Temperature Range	-18 °C / -24 °C	-18 °C / -24 °C
Classe Climatica / Climate Class	4	4
Volume Netto-Lordo / Net-Gross Volume	Lt. 361 / 382	Lt. 361 / 382
Superficie Esterna / Body	Lamiera preverniciata con trattamento anticorrosione Prepainted sheet with anticorrosion treatment	Lamiera preverniciata con trattamento anticorrosione Prepainted sheet with anticorrosion treatment
Superficie Interna / Inner Liner	ABS	ABS
Termometro / Thermometer	Analogico / Analogue	Analogico / Analogue
Regolatore temperatura / Controller	Meccanico / Mechanical	Meccanico / Mechanical
Spessore isolamento / Insulation thickness	mm 60	mm 60
Sbrinamento / Defrost	Manuale / Manual	Manuale / Manual
Illuminazione / Lighting	1 Led orizzontale / Horizontal	1 Led orizzontale / Horizontal
Chiusura automatica porta / Self closing door	Si / Yes	Si / Yes
Chiave e serratura / Lock and key	Si / Yes	-
Mensole (LxP) / Shelves (WxD)	N° 5 - mm 488 x 392	N° 5 - mm 488 x 392
Piedi-Ruote / Feet-Rollers	2 Piedini - 2 Ruote 2 Feet - 2 Rollers	2 Piedini - 2 Ruote 2 Feet - 2 Rollers
Peso Netto-Lordo / Net-Gross Weight	Kg 100 / 109	Kg 98 / 106
Voltaggio / Voltage	V 220-240	V 220-240
Frequenza / Frequency	Hz 50	Hz 50
Refrigerante / Refrigerant	R404A / R290	R404A / R290
Assorbimento / Absorption	W 598	W 598
Consumo Energia / Energy Consumption	KwH/24H 15,6	KwH/24H 15,0

Dimensioni mm / Dimensions mm

Modello / Model	FR 372 VGC ST	FR 372 V ST B/W
Dimensioni Esterne (LxPxH) External Dimensions (WxDxH)	640 x 670 x 2056	640 x 670 x 1875
Dimensioni Imballo (LxPxH) Packaging Dimensions (WxDxH)	650 x 710 x 2160	650 x 710 x 1975

Dimensioni Interne mm / Inner Dimensions mm

A - Larghezza / Width	490	490
B - Profondità / Depth	469	469
C - Altezza / Height	1570	1570
D - Profondità Min. / Min. Depth	259	259
E - Altezza Min. / Min. Height	1470	1470

Dimensioni Personalizzazione (LxH) mm / Sticker Dimensions (WxH) mm

Lato / Side	537 x 2020	537 x 1832
Vetro / Glass	548 x 1560	548 x 1560
Opalina / Canopy	625 x 187	-

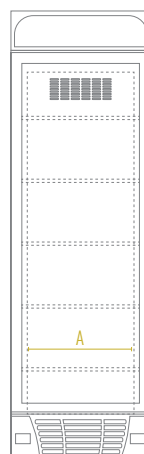
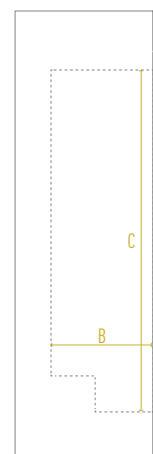
 FR 372 VGC ST
FRONTE / FRONT

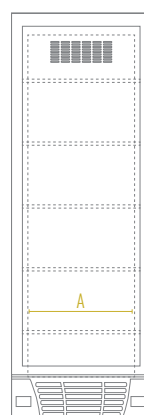
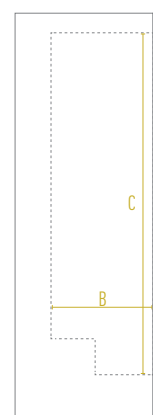
 FR 372 VGC ST
LATO / SIDE

 ALTEZZA RIPIANI / SHELVES HEIGHT
 220 mm
 270 mm
 265 mm
 265 mm
 265 mm
 100 mm

 FR 372 V ST
FRONTE / FRONT

 FR 372 V ST
LATO / SIDE

 ALTEZZA RIPIANI / SHELVES HEIGHT
 220 mm
 270 mm
 265 mm
 265 mm
 265 mm
 100 mm